

# Motoranbau- anleitung PLS-HP-Serie

# Motormounting instruction PLS-HP-Line

1.

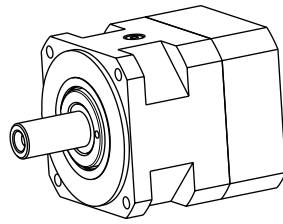

DIN 42955-R  
richtiger Motor? / right motor? richtiges Getriebe? / right gear?

3.

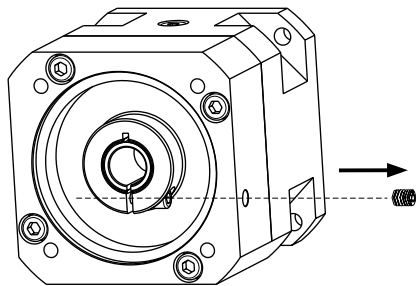

Abdeckschraube entfernen / remove cover screw  
Stellung der Klemmschraube justieren / adjust position of clamping screw

5.

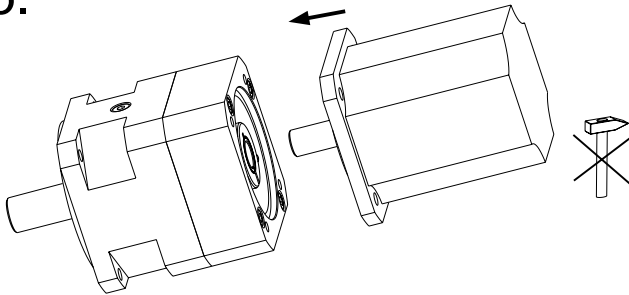

Motor in Getriebe fügen / fit the motor in the gear

7.

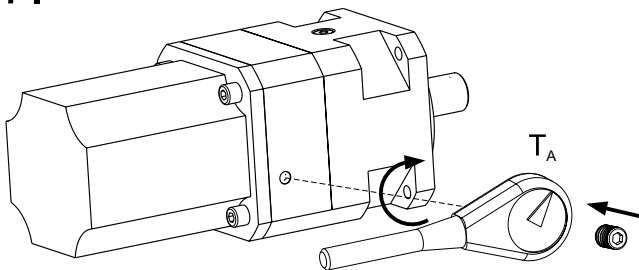

2.

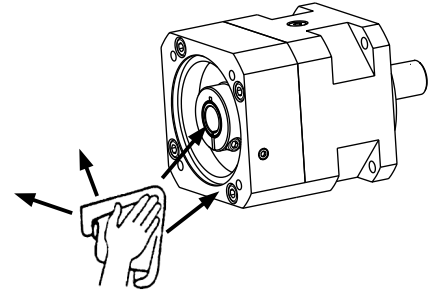

fettfrei reinigen / clean grease free  
Beschädigungen entfernen / rectify any damages

4.



bei Motor mit Paßfeder muß diese entfernt werden  
if the motor has a keyway remove it

6.

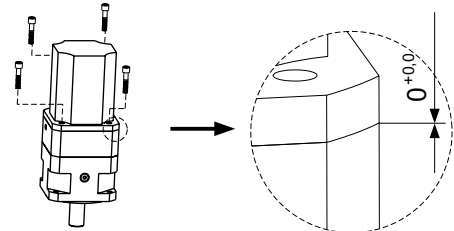

Motorflansch muß an Getriebeflansch anliegen  
Schrauben über kreuz anziehen  
motor flange adjacent on gear flange  
screws tighten crosswise

Getriebe gear box	PLS 70 HP	PLS 90 HP	PLS 115 HP		PLS 142 HP	
Wellendurchmesser shaft diameter	<= 19	<= 24	<= 24	> 24	<= 35	> 35
T <sub>A</sub> [ Nm ]	9,5	16,5	16,5	40	40	75
SW [ mm ]	4,5	5	5	6	6	8