

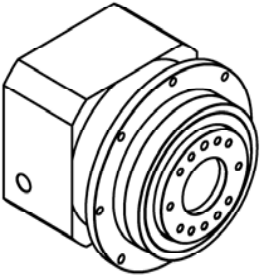

PLF-HP
 High Performance Planetary Servo Gearhead
 With EN ISO 9409 Rotating Output Flange
 Dimensional Data

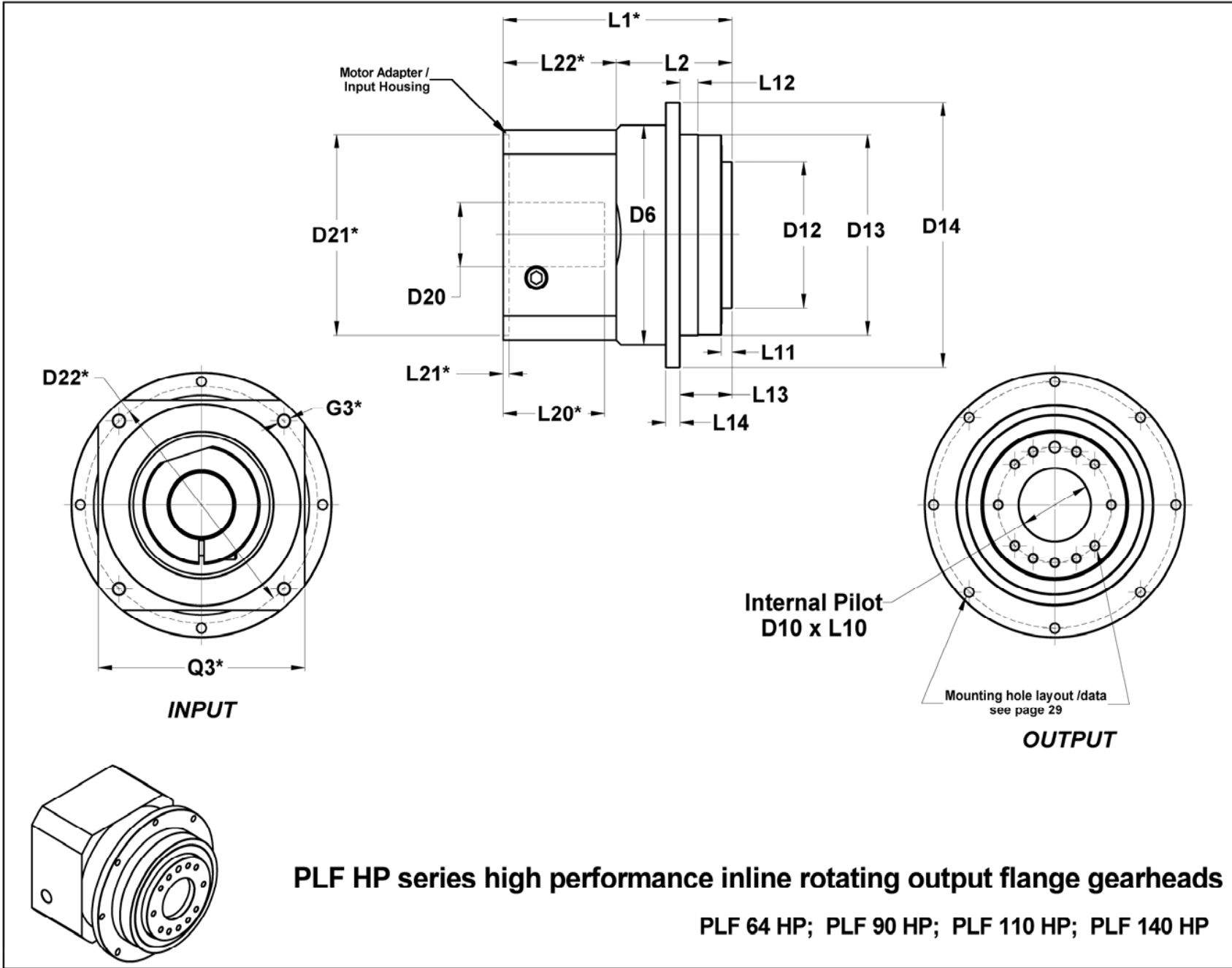



PLF-HP

**High Performance Planetary Servo Gearhead
With EN ISO 9409 Rotating Output Flange
Dimensional Data**



Dimensions	mm (inch)	Tol.	PLF 64 HP	PLF 90 HP	PLF 110 HP	PLF HP 140
D6	Gearhead body diameter	•	70 (2.756)	95 (3.740)	120 (4.724)	155 (6.102)
D10	Rotating flange pilot BORE diameter	h7	20 (0.787)	31.5 (1.240)	40 (1.575)	50 (1.969)
D12	Rotating flange OUTSIDE diameter	h7	40 (1.575)	63 (2.480)	80 (3.150)	100 (3.937)
D13	Stationary flange pilot diameter	h7	64 (2.519)	90 (3.543)	110 (4.331)	140 (5.512)
D14	Stationary (outer) flange OD	•	86 (3.386)	118 (4.646)	145 (5.709)	179 (7.047)
D20	Maximum input pinion bore ⁽¹⁾	•	19 (0.748)	24 (0.945)	35 (1.378)	48 (1.890)
L2	Gearhead body length	1-Stage	• 59 (2.323)	• 64.5 (2.539)	• 89.5 (3.524)	• 122.5 (4.823)
		2-Stage	• 91.5 (3.602)	• 106 (4.173)	• 136 (5.354)	• 198.5 (7.815)
L10	Rotating flange pilot BORE depth	•	4 (0.157)	6 (0.236)	6 (0.236)	6 (0.236)
L11	Rotating flange (OD) pilot length	•	3 (0.118)	6 (0.236)	6 (0.236)	6 (0.236)
L12	Stationary flange pilot length	•	7 (0.276)	10 (0.394)	10 (0.394)	12 (0.472)
L13	Length from mounting face	•	19.5 (0.768)	30 (1.181)	29 (1.142)	38 (1.496)
L14	Stationary flange thickness	•	4 (0.157)	7 (0.276)	8 (0.315)	10 (0.394)
Available standard bushings ⁽¹⁾	mm		9.525; 10; 11; 12; 12.7; 14; 15.875; 16;	11; 12.7; 14; 15.87; 16; 19; 19.05; 22; 22.22	19; 22; 24; 28; 28.575; 32	28; 32; 35; 38; 42
		inch	.375; .394; .433; .472; .500; .551; .630	.433; .500; .551; .625; .630; .748; .750; .866; .875	.748; .866; .945; 1.125; 1.260;	.945; 1.1260; 1.378; 1.496; 1.654;
Motor dependent dimensions: D21*, D22*, L1*, L20*, L21*, L22*, G3*, Q3* (L22* length calculation see page 7)		Adapter / Input Housing dimensions and unit overall length depend on motor output geometry. A motor-specific adapter / input housing is supplied with every gearhead.				

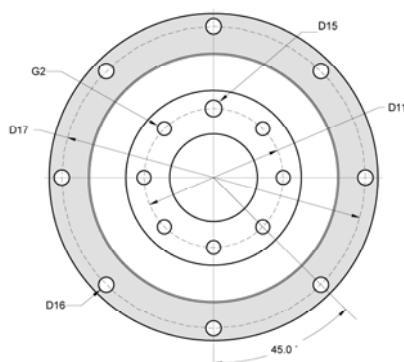

PLF 64 HP & PLF 90 HP

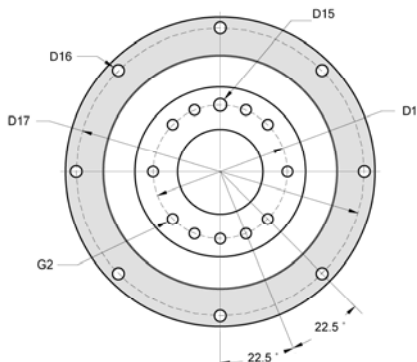

PLF 110 HP

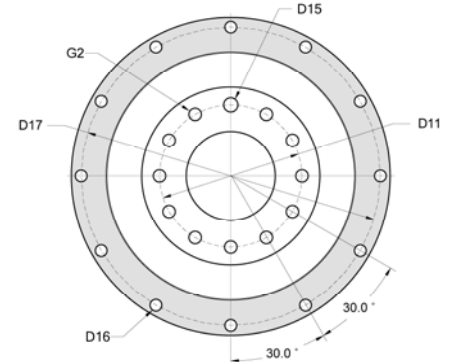

PLF 140 HP

Stationary & rotating flange bolting dimensions	mm (inch)	PLF 64 HP	PLF 90 HP	PLF 110 HP	PLF HP 140
D11	Rotating flange bolt circle diameter	31.5 (1.240)	50 (1.969)	63 (2.480)	80 (3.150)
D15	Index / dowel bore diameter x depth	5 x 6 (0.197 x 0.236)	6 x 7 (0.236 x 0.276)	6 x 7 (0.236 x 0.276)	8 x 6 (0.315 x 0.236)
D16	Stationary flange bolt hole # / diameter (SHADED AREA)	8 / 4.5 (0.177)	8 / 5.5 (0.217)	8 / 5.5 (0.217)	12 / 6.6 (0.260)
D17	Stationary flange bolt circle diameter (SHADED AREA)	79 (3.110)	109 (4.291)	135 (5.315)	168 (6.614)
G2	Rotating flange bolt hole # / M size x depth	7 / M5 x 7	7 / M6 x 10	11 / M6 x 12	11 / M8 x 15