

Motoranbau- anleitung PLE-Serie B5

Motormounting instruction PLE-Line B5

1.

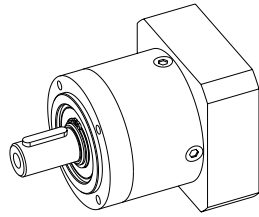

DIN 42955-N
richtiger Motor? / right motor? richtiges Getriebe? / right gear?

3.

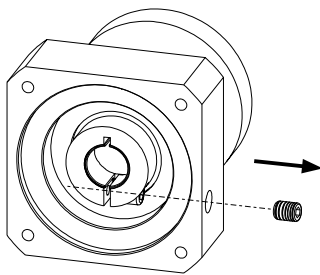

Abdeckschraube entfernen / remove cover screw
Stellung der Klemmschraube justieren / adjust position of clamping screw

5.

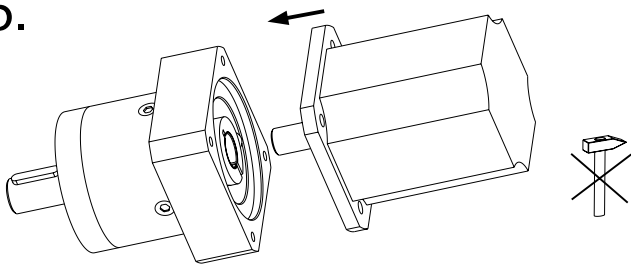

Motor in Getriebe fügen / fit the motor in the gear

7.

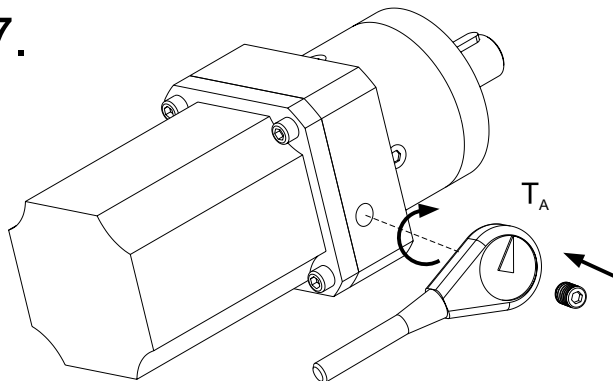

2.

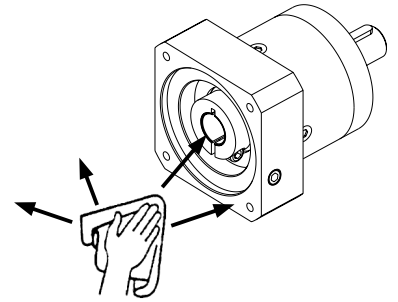

fettfrei reinigen / clean grease free
Beschädigungen entfernen / rectify any damages

4.



bei Motor mit Paßfeder muß diese entfernt werden
if the motor has a keyway remove it

6.

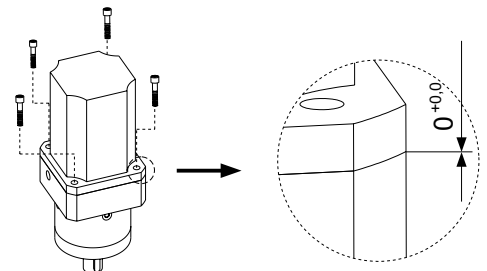

Motorflansch muß an Getriebeflansch anliegen
Schrauben über kreuz anziehen
motor flange adjacent on gear flange
screws tighten crosswise

Getriebe Gear	PLE 40	PLE 60	PLE 80 - 80/90	PLE 120 - 120/115	PLE 160
T _A [Nm]	2	4,5	9,5	16,5	40
SW [mm]	2,5	3	4	5	6

Motoranbau- anleitung PLE-Serie B14

Motormounting instruction PLE-Line B14

1.

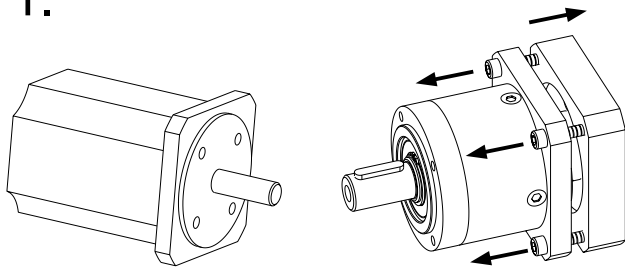

DIN 42955-N
richtiger Motor? / right motor?
richtiges Getriebe? / right gear?
lösen der Adapterplatte, falls montiert
unmount the adapter plate if mounted

2.

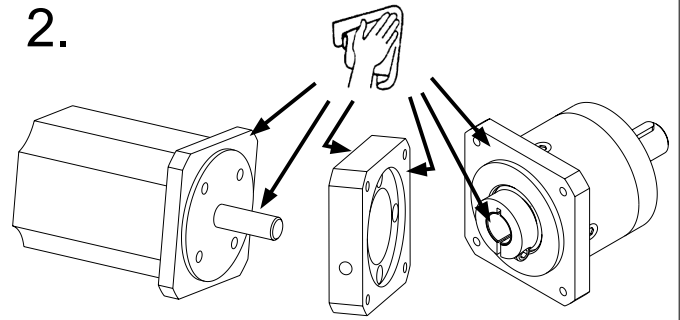

fettfrei reinigen / clean grease free
Beschädigungen entfernen / rectify any damages

3.

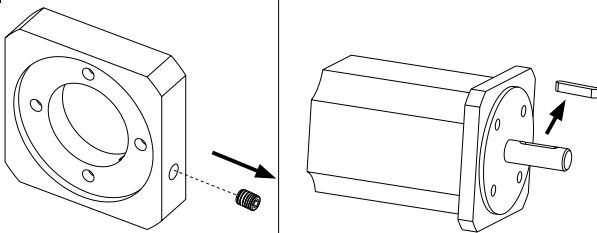

Abdeckschraube entfernen
remove cover screw

bei Motor mit Paßfeder muß
diese entfernt werden /
if the motor has a keyway
remove it

4.

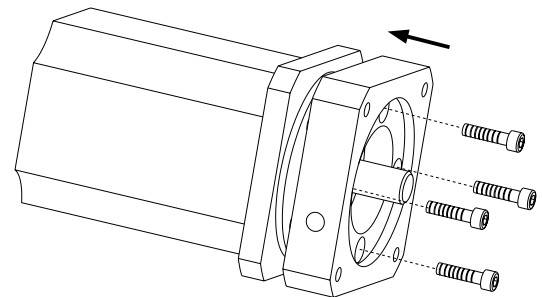

Adapterplatte an Motor montieren / mount adapter plate to motor

5.

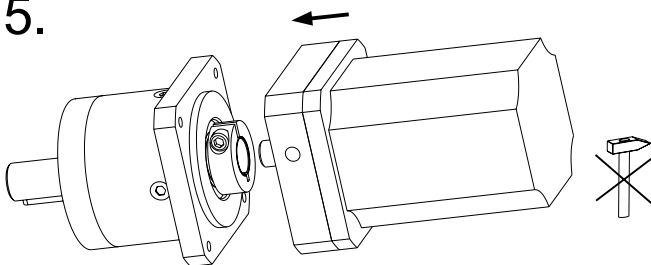

Motor in Getriebe fügen / fit the motor in the gear
Stellung der Klemmschraube justieren
adjust position of clamping screw

6.

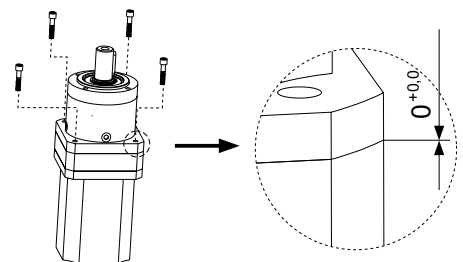

Motorflansch muß an Getriebeflansch anliegen
Schrauben über kreuz anziehen
motor flange adjacent on gear flange
screws tighten crosswise

7.

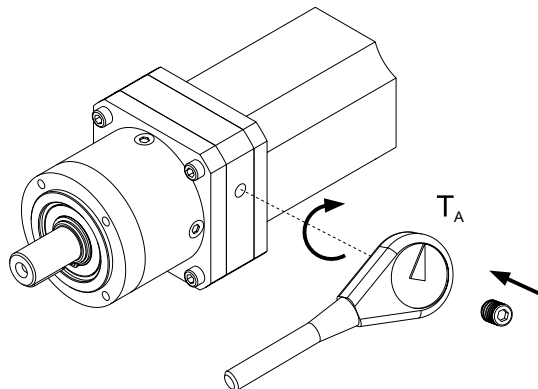

Getriebe Gear	PLE 40	PLE 60	PLE 80 - 80/90	PLE 120 - 120/115	PLE 160
T _A [Nm]	2	4,5	9,5	16,5	40
SW [mm]	2,5	3	4	5	6